

# Type 39C 4U –19" Rack Mount/Desktop, Horizontal



## Features

- 19" Rack mount fully compliant to IEEE 1101.10/.11
- 4U x 443mm x 300mm (H x W x D)
- 4, 6 or 8 slot, PICMG: 2.0, 2.16, 2.17, 2.20 backplanes (H.110 optional)
- Cooling side to side (200 CFM), plug removable
- Removable air filter tray
- Advanced EMC shielding to meet CE, FCC Class A and NEBS
- Wide range of PSU inputs (90 – 264 VAC, 48 VDC)
- Wide range of PSU options: fix mount, plug in, N+1
- Shelf Management: PICMG 2.9, IPMI (optional)
- Ready to run – turnkey solution

## Scope of Supply

High quality platform consisting of black painted sheet steel enclosure, high performance PICMG 2.0, 2.16, 2.17 or 2.20 backplane, power supply, cooling system and AC/DC power components. Assembled, wired and tested prior to shipment.

## Order Information

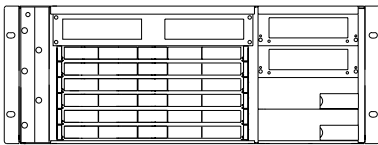

Description	Order Number
<ul style="list-style-type: none"> <li>■ 4U H x 443mm W x 300mm D</li> <li>■ 6 slot, 6U x 160mm, front</li> <li>■ 6 slot, 6U x 80mm, rear I/O</li> <li>■ 6 slot BP, (PICMG 2.0, wo/H.110)</li> <li>■ 4 x 3.5" devices</li> <li>■ 7 fans(200 CFM total), side to side, plug removable</li> <li>■ 2 x 200W, PSU – 3U, plug removable, N+1</li> </ul>	<p><b>39C06AD548Y3HP2X</b></p>

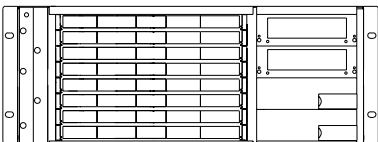

Description	Order Number
<ul style="list-style-type: none"> <li>■ 4U H x 443mm W x 300mm D</li> <li>■ 8 slot, 6U x 160mm, front</li> <li>■ 8 slot, 6U x 80mm, rear I/O</li> <li>■ 8 slot BP, (PICMG 2.16, 2 x FS wo/H.110)</li> <li>■ 2 x 3.5" devices</li> <li>■ 7 fans(200 CFM total), side to side, plug removable</li> <li>■ 2 x 200W, PSU – 3U, plug removable, N+1</li> </ul>	<p><b>39C08FD248Y3HP2X</b></p>

## Line Drawings

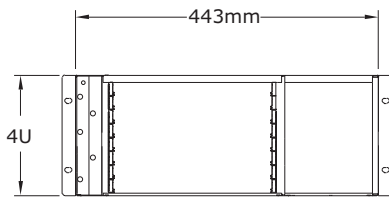

Front View

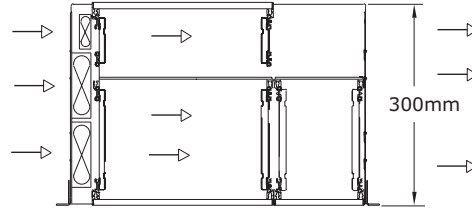

Top View

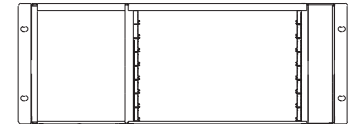

Rear View

## Environmental

	Operating	Storage/Transit
<b>Temperature:</b>	0°C to +50°C	-20°C to +70°C
<b>Altitude:</b>	6000 ft. (1,829m)	50,000 ft. (15,240m)
<b>Humidity:</b>	5% to 95% Non condensing	5% to 95% Non condensing
<b>Shock:</b>	10 G's @ 11ms	15 G's @ 11ms (per ASTM 0775)
<b>Vibration:</b>	1.0 G's @ 10 to 330 Hz	1.2 G's @ 5 to 330 Hz
<b>Agencies:</b>	Designed to meet UL60950, FCC Class A, A, CE	

## Custom Configurations

3 9 C      4 8 Y 3 H

### Backplane Configuration

00-21: Single BP, AA-YY: Split  
 02 = 2 slot  
 04 = 4 slot  
 06 = 6 slot  
 08 = 8 slot

### Bare Board

A = 6U Eco, ATX, (RSS)  
 B = 3U Rev. 2.0  
 C = 6U H110  
 D = 6U (LSS)  
 E = 2.16, 1 x FS (no H.110)  
 F = 2.16, 2 x FS (no H.110)  
 H = 2.16, 2 x FS (w/ H.110)  
 I = 2.16, 1 x FS (w/ H.110)  
 X = No BP installed  
 Z = Custom

### BP Connector

A = P1 & P2 S; No P3,P4, P5  
 B = P1 S, P2 L; No P3,P4, P5  
 C = P1, P2 & P4 S; P3 & P5 L  
 D = P1 & P2 S; P3, P4, P5 L  
 E = P1 S; P2, P3, P4, P5 L  
 F = P1 & P4 S; P2, P3, P5 L  
 G = P1 & P2 S; P3 L, no P4, P5  
 H = 2 x PC: P1, P2 & P4 S; P3 & P5 L  
 I = 2 x 47 PIN Power  
 X = No connectors  
 Z = Custom

### Drives

1 = 1 X 3.5"  
 2 = 2 X 3.5"  
 3 = 1 X 5.25"HH  
 4 = 2 X 5.25"HH  
 5 = 4 X 3.5"HH  
 6 = 2 X 3.5", 1 X 5.25"HH  
 9 = 1 X 3.5", 1 X 5.25"HH  
 A = 1 x 2.5", 1 X CDROM (SL)  
 B = 2 x 2.5"  
 X = Not installed

### Height

4 = 4U

### Width

8 = 84HP (443mm)

### Rear IO

Y = Yes

### Depth

3 = 300mm

### Card Orientation

H = Horizontal

### PSU Input

C = 90-230VAC (Fixed)  
 E = 110/220VAC (2 x HS, N+1)  
 G = 90-230VAC (Plug In)  
 H = 48VDC (Plug In)  
 K = 48VDC (Fixed)  
 L = 48VDC (2 x QC, N+1)  
 M = 48VDC (2 x HS, N+1)  
 P = 90-230VAC (2 x HS, N+1)  
 Q = 90-230VAC (3 x HS, N+1)  
 R = 28VDC (Fixed)  
 S = 48VDC (3 x HS, N+1)  
 X = No PSU

### PSU Output

(Note: Not all PSU combinations available)  
 1 = 150 W  
 2 = 200/250 W (4U, 6U or fixed)  
 3 = 300 W (4U/6U, ATX)  
 4 = 350 W (6U plug in only)  
 5 = 350 W (Brick)  
 6 = 500 W (Brick)  
 7 = 300 (4U or 6U, PS2 Hot Swap)  
 8 = 200 W (6U x 4T)  
 X = Not installed

### Voltage IO

3 = 3.3V  
 5 = 5V  
 X = Not installed